

NOTES

1. DISCONNECT POWER CABLE AND UNBOLT OLD STARTER FROM THE ENGINE.
2. MOUNT NEW STARTER USING THE NEW LOCK WASHERS SUPPLIED AND TORQUE TO 100 IN. POUNDS.
3. REMOVE THE CRANKING INFORMATION TAG FROM THE NEW STARTER BY REMOVING THE 8MM NUT FROM THE POWER TERMINAL AND PLACE THE TAG IN CUSTOMER'S LOG.
4. ATTACH POWER CABLE USING A 13MM WRENCH ON THE 8MM NUT PREVIOUSLY REMOVED FROM THE POWER TERMINAL AND TORQUE TO 50 IN. POUNDS (DO NOT OVERTORQUE, INSULATOR WILL BREAK).
5. PLACE A MS25171 INSULATING NIPPLE OF THE PROPER SIZE ON THE POWER TERMINAL.
6. CONTINUING AIRWORTHINESS: THE STARTER SHOULD BE RETURNED TO THE FACTORY FOR OVERHAUL AT 2700 HOURS OF ENGINE OPERATION, OR WHEN A MAJOR OVERHAUL OF THE ENGINE IS PERFORMED, OR IF SERVICING IS REQUIRED. AN OCCASIONAL DROP OF OIL CAN BE PLACED ON THE PINION SHAFT TO HELP PREVENT RUST FROM FORMING. NO OTHER MAINTENANCE IS REQUIRED OR RECOMMENDED.

REVISIONS

LTR.	DESCRIPTION	DATE	APRV.
A	ADDED 24 VOLT MODELS	2/20/95	TCW
B	ADDED PLATFORM HEIGHT	5/15/95	TW
C	ADDED NOTES & CUTOFF	8/27/95	TW
D	ADDED PMA MARKINGS	12/04/97	LES
E	DELETED MODULE, EXTEND CASE	3/02/98	EC
F	REVISED PMA MARKINGS	9/22/98	EC
G	COMBINED LS & PM INSTALLATIONS, ADDED NOTES, REDRAWN	5/22/06	EC

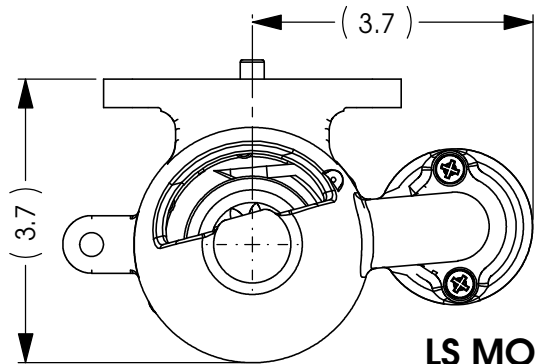

LS MODEL

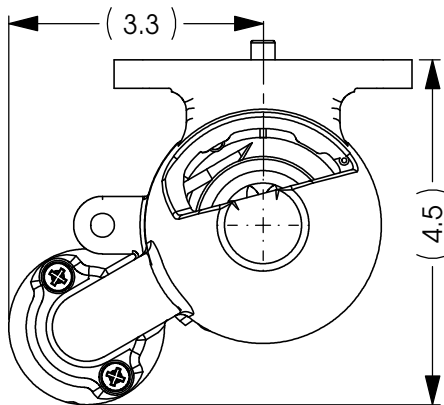
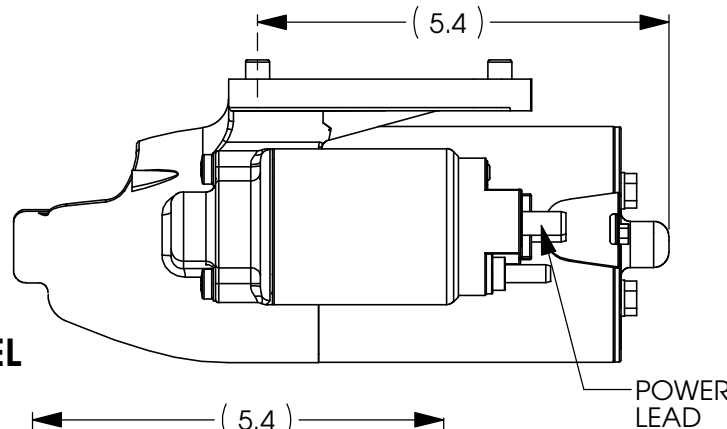

PM MODEL

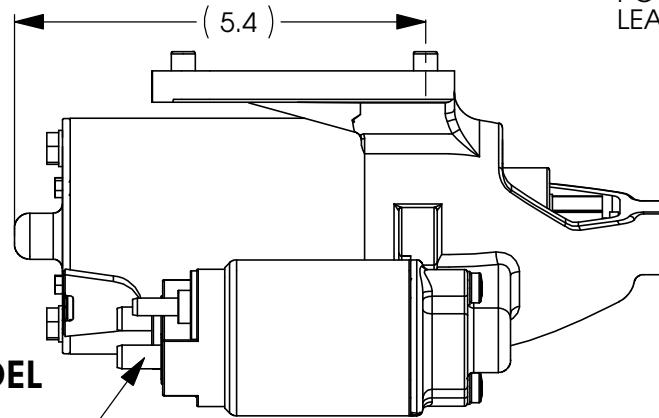

PMA LABEL

INSTALLATION AIDS

6" EXTENSION
P/N BCE-6 (20139 KIT)

RIGHT ANGLE CONTACT BRACKET KIT
P/N 2405

PMA LABEL DATA CHART

MODEL	S/N	PITCH	VOLTS	MODEL	S/N	PITCH	VOLTS
122-12LS	C2L-	10/12	12	122-12PM	C2P-	10/12	12
149-12LS	F2L-	12/14	12	149-12PM	F2P-	12/14	12
122-24LS	C4L-	10/12	24	122-24PM	C4P-	10/12	24
149-24LS	F4L-	12/14	24	149-24PM	F4P-	12/14	24

2-1/4"

Sky-Tec FAA-PMA

Eligible on: Lycoming 235, 290, 320, 360, 540, & 541 engines.

Model No. Serial No.

122-12LS **C2L-XXXXXX**

Pitch Volts

Pitch **10/12** Volts **12**

1-1/4"

Sky-Tec Partners, Ltd.
Granbury, Texas

LS/PM INSTALLATION INSTRUCTIONS

DRAWN BY: Tom Williams	DATE 6/07/93
MATERIAL	DWG. NO. 20101
	REV. G